

Tight shutoff dampers **FLX-DAT...**

[Download Wentyle](#)
[Download AlnorCAM](#)
[Buy via B2B](#)



Description

FLX-DAT damper may be used wherever a tight seal is required. Its main function is to shut off the air flow. Damper adjustment angle range is 90°.

FLX-DAS dampers are made of galvanized steel.

On special request, it is possible to make the plenum boxes using stainless steel.

Example

Kod produktu: **FLX - DAT - 75**

type

diameter

Dimensions

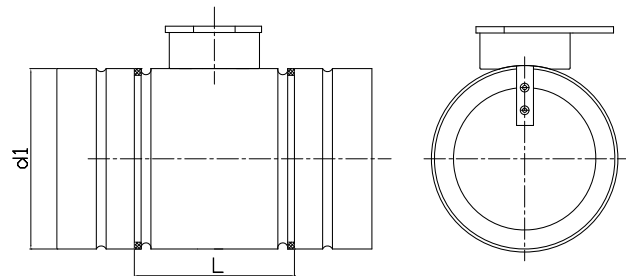

code	d1 [mm]	L [mm]
FLX-DAT-75	75	110
FLX-DAT-90	90	110